



© BMW Group
Plant Debrecen, Hungary

CLICK+GO

FACADE MOUNTING SYSTEM

1 VERSATILE
Universal for PV modules and facade structures

2 INVISIBLE
Concealed mounting on facade structures

3 FAST
Fast and easy installation

4 CERTIFIED
Patented, tested and certified system

CLICK&GO IS PART OF THE BIPV+ PORTFOLIO
HARDWARE | SERVICE | PROOF



System type	Modular and axle-on-rail based facade mounting system for Building Integrated / Applied Photovoltaics (BIPV/BAPV) with universal fitting connectors to PV module
Application	New build and renovation projects Industrial, residential, utility and infrastructural facilities
Wall structure	Types: concrete, stone and steel supporting structures, sandwich panels Insulated and non-insulated wall systems Patented facade-strengthening options available for limited load-bearing facades
Rails and connections	Corrosion-resistant steel Omega profile Concealed mounting behind the PV module Direct and individual module mounting / de-mounting possible Weight of system: 4-6 kg/m ²
PV module options	Compatible with framed & frameless PV modules (glass-glass), in both landscape and portrait orientation
Electrical integration	Compatible with standardized cable ducts and fasteners for safe and clean cable management
Guarantee	20-year product warranty on all CLICK+GO mounting systems
Installation requirements	Manuals provided Easy tooling

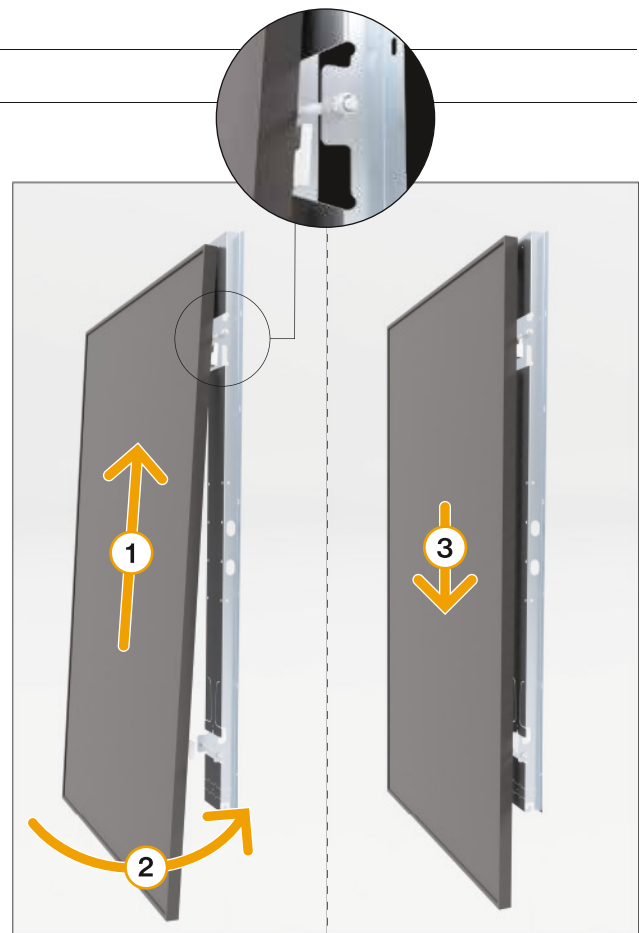
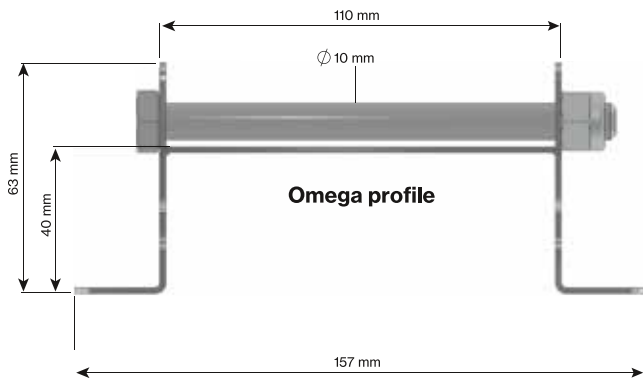

National Environmental Database (NMD) with a category 1 environmental declaration and a lifespan of 60 years. Scope 12 compatible.



WIND : EAD 090062-01-0404 – 6000+ N/m²
FIRE : EN_13501-C-s1, d0 level



BIPV+ Industrieweg 92a
5145 PW WAALWIJK
Netherlands

T +31 (0)85 124 8300
W www.bipvplus.com
E sales@bipvplus.com

KVK 17273239
IBAN NL57RABO 0154 4974 28
BTW NL821762199B01